

Taper Pressure Plugs DIN 906

Metric



Precision thread for positive seal without sealing compound; controlled chamfer for faster starting.

Mechanical Properties

Thread shall conform to DIN 158
Heat Treatment: 35-40 HRC

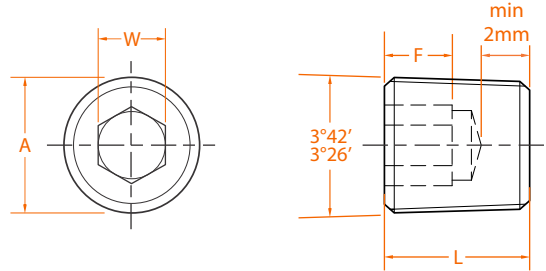

Product Dimensions

Nom Dia	Pitch	Head Diameter A		Hex Socket Size W		Length L		Socket Depth F	Socket Drill Size
		max	min	max	min	max	min	min	
M8	1	6.66	6.41	4.07	4.02	8.25	7.75	4.00	4.14
M10	1	8.66	8.41	5.08	5.02	8.25	7.75	4.00	5.15
M12	1.5	10.09	9.84	6.09	6.02	10.25	9.75	5.00	6.17
M14	1.5	12.09	11.84	7.11	7.03	10.25	9.75	5.00	7.20
M16	1.5	14.09	13.84	8.11	8.03	10.25	9.75	5.00	8.20
M18	1.5	16.09	15.84	8.11	8.03	10.25	9.75	5.00	8.20
M20	1.5	18.09	17.84	10.12	10.03	10.25	9.75	5.00	10.23
M22	1.5	20.09	19.84	10.12	10.03	10.25	9.75	5.00	10.23
M24	1.5	22.22	21.97	12.13	12.04	12.25	11.75	6.00	12.28
M26	1.5	24.22	23.97	12.13	12.04	12.25	11.75	6.00	12.28
M30	1.5	28.22	27.97	17.15	17.05	12.25	11.75	6.00	17.30