

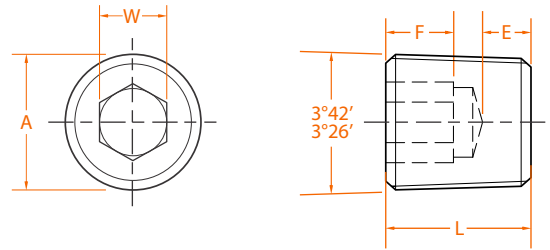

Features 3/4" taper. Precision thread for positive seal without sealing compound; controlled chamfer for faster starting.

### Mechanical Properties

Heat Treatment: 35-40 HRC



### Product Dimensions

Plug Size	Threads per Inch	Head Diameter A		Hex Socket Size W nom	Socket Depth F min	Length L	
		max	min			max	min
1/8	28	0.329	0.319	0.1875	0.183	0.385	0.365
1/4	19	0.438	0.428	0.2500	0.245	0.510	0.490
3/8	19	0.578	0.568	0.3125	0.276	0.573	0.553
1/2	14	0.731	0.721	0.3750	0.339	0.698	0.678
5/8	14	0.808	0.798	0.5000	0.370	0.760	0.740
3/4	14	0.946	0.936	0.5625	0.370	0.823	0.803
7/8	14	1.098	1.088	0.5625	0.442	0.885	0.865
1	11	1.181	1.171	0.6250	0.558	1.010	0.990
1 1/4	11	1.530	1.520	0.7500	0.677	1.260	1.240
1 1/2	11	1.754	1.744	0.7500	0.677	1.260	1.240

Plug Size	E min	Socket Drill Size
1/8	0.076	0.1923
1/4	0.107	0.2564
3/8	0.139	0.3205
1/2	0.170	0.3847
5/8	0.170	0.5129
3/4	0.232	0.5770
7/8	0.232	0.5770
1	0.232	0.6400
1 1/4	0.300	0.7680
1 1/2	0.300	0.7680