

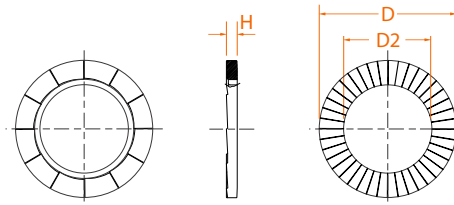

Durlok washers are designed for use with standard hex bolts & nuts. Self-locking. Anti-vibration.

Mechanical Properties

Material: SAE 4130 or equivalent alloy.
Through Hardened.
Plating: Zinc flake coating (Delta Protekt(R))
Heat treatment: 47-52 HRC



Product Dimensions

Size	D		D2		H	
	min.	max	min.	max	min.	max
6mm	10.60	11.00	6.40	6.60	0.80	1.00
8mm	13.30	13.70	8.60	8.80	1.15	1.35
10mm	16.40	16.80	10.60	10.80	1.15	1.35
12mm	19.30	19.70	12.90	13.10	1.15	1.35
14mm	22.80	23.20	15.10	15.30	1.60	1.80
16mm	25.20	25.60	16.90	17.10	1.60	1.80
20mm	30.50	30.90	21.30	21.50	1.60	1.80
24mm	38.80	39.20	25.30	25.50	1.60	1.80

Product Range

Size	Part No.		\$ Price /100	lbs /1000
Zinc Flake Coated				
M6	183794	200	57.70	0.91
M8	183795	200	61.40	1.80
M10	183796	200	69.90	2.73
M12	183797	200	114.30	3.58
M14	183798	100	140.30	5.88
M16	183799	100	166.30	8.45
M20	183801	100	249.40	11.50

About Durlok Washers

Durlok® locking wedge washers when used with standard or high grade screws helps achieve self-locking properties. It utilizes tension instead of friction to secure bolted joints. Durlok washers come pre-assembled in pairs. They have wedge faces on the inside and radial teeth on the outside. They are designed such that the wedge angle is greater than the thread angle.

When the screw or the nut is tightened the radial teeth of Durlok washer locks itself onto the surface, allowing movement only across the wedge faces. During vibration, even a smallest turn of the screw causes an increase in pre-load force due to the wedge effect and the screw locks itself.

Thus the screw will not loosen or unscrew, even under severe jarring & vibration. Durlok washers are re-usable with locking ability maintained.

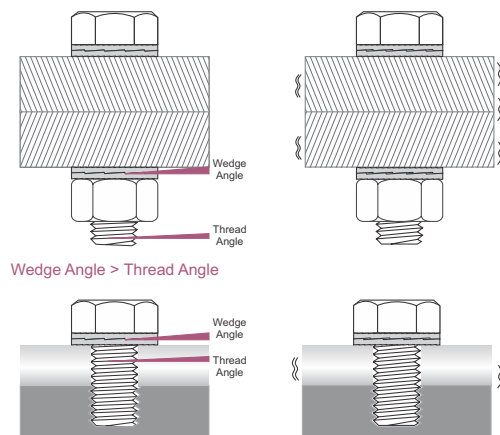

Note: the washers are always used in pairs. For through holes two pairs of Durlok washers should be used. For studbolt Durlok washers lock the nut. Durlok washers must not be used with other flat washers.